



660 E. Ringgold Street
Brownsville, Texas 78520
(956) 542-0941

Proposal for Solo Exhibition or Group Exhibition

Proposals are accepted on a rolling basis and are reviewed as received.

The mission of the Brownsville Museum of Fine Art includes the exhibition of contemporary art. The BMFA is accepting proposals for solo exhibitions, group exhibitions, and curated proposals for group exhibitions. The selected exhibitions will be at a professional level, innovative, educational, inclusive, and serve a diverse audience.

Proposals should demonstrate a consistency of vision and include:

- New and original works that have not previously been exhibited in Brownsville or the lower Rio Grande Valley,
- a clearly articulated central theme or concept,
- artworks that address relevant social and cultural issues in the community,
- relevant themes in contemporary art,
- an Artist's Talk and creative supplemental programming that compliments the proposed exhibition, i.e., workshops, lectures, panel discussions, educational events, workshops, etc.

If selected, we will require the specifications of what will be included in the exhibition, an artist's statement for display, and a listing of specifics about each work for labels. While we respect your original artistic vision, we retain the right to edit the exhibition. Selection will be based on the artwork submitted and there cannot be any substitutions or changes to the body of work. Gallery and month requests are not guaranteed and final decisions are based on the overall exhibition schedule.

Mail entire application on CD or flash drive to: Executive Director, BROWNSVILLE MUSEUM OF FINE ART, 660 E. Ringgold Street, Brownsville, Texas 78520

OR

hand-delivery to BMFA Reception Desk, Attention: Executive Director.

BMFA Board Approved 2-15-22

Proposal for Solo Exhibition

1. Letter of Intent / Proposal for Your Exhibition

- Your name, address, phone, email.
- Please specify the proposed Title for the exhibition.
- We encourage you to consider the creation of new work for this Solo Exhibition.
- We will not consider for exhibition any work that is more than five (5) years old.

2. Artist's Statement:

What is the subject matter you explore? Why do you use your chosen medium/media? What motivates you to create art? etc.

3. Resumé / CV:

Please highlight your art training and previous exhibitions.

4. Images:

Include on a CD or flash drive five (5) to ten (10) examples of the work you **will** exhibit. Label each piece: ArtistName_1, ArtistName_2, ArtistName_3, etc.

5. Image List:

List artworks (ArtistName_1, ArtistName_2, etc.) that you would bring if you were invited to present your work to the Exhibitions Committee in person at the Museum or via ZOOM or a local RGV studio visit.

- Title
- Medium/media
- Dimensions in inches (Height x Width x Depth)
- Date completed
- Brief comments or description of the artwork
- Preferred exhibition space as shown in the Attachment
- Price (includes 30% commission to BMFA); all work must be for sale
- Insurance value (Museum insures the artworks during the exhibition.)

6. Preferred Exhibition Space:

Please refer to the floor plan for the Museum and indicate your preferred exhibition space:

Atrium or North Atrium or Central Atrium or South Atrium
Permanent Collection Gallery or ½ Permanent Collection Gallery
Main Gallery or ½ Main Gallery or 1/3 Main Gallery
Sitting Room / Crepe Town Café

7. Application Fee:

There will no fee for yearly paid BMFA Members.

Non-BMFA members: Enclose a check for \$25.00 **when** mailing or hand delivering your application. If your application is accepted for a solo exhibition, you may choose to become a yearly BMFA member for an additional \$35.00.

NOTE: Any packing, shipping, or insurance costs during shipping are the responsibility of the artist.

Proposal for Group Exhibitions

1. Letter of Intent / Proposal for Your Exhibition

- The name, address, phone, email for each artist.
- Please specify one (1) contact person.
- Please specify the proposed Title for the exhibition.
- We encourage you to consider the creation of new work for this Group Exhibition.
- We will not consider for exhibition any work that is more than five (5) years old.

2. Artists' Statement for the Group:

What is the subject matter you explore? Why do you use your chosen medium/media?
What motivates you to create art? etc.

3. Resumé / CV for Each Artist:

Please highlight your art training and previous exhibitions.

4. Images for Each Artist:

Include on a CD or flash drive three (3) examples of the work each artist will exhibit.
Label each piece: ArtistName_1, ArtistName_2, ArtistName_3

5. Image List for Each Artist:

List artworks (ArtistName_1, ArtistName_2) that each artist would bring if your group were invited to present your work to the Exhibitions Committee in person at the Museum or via ZOOM or a local RGV studio visit.

- Title
- Medium/media
- Dimensions in inches (Height x Width x Depth)
- Date completed
- Brief comments or description of the artwork
- Price (includes 30% commission to BMFA); all work must be for sale
- Insurance value (Museum insures the artworks during the exhibition.)

6. Preferred Exhibition Space:

Please refer to the floor plan for the Museum and indicate your preferred exhibition space:

Atrium or North Atrium or Central Atrium or South Atrium
Permanent Collection Gallery or ½ Permanent Collection Gallery
Main Gallery or ½ Main Gallery or 1/3 Main Gallery
Sitting Room / Crepe Town Café

7. Application Fee:

Enclose a check for \$40.00 when mailing or hand delivering application. [There will no fee for non-profit 501(c) art organizations nor will there be a fee for groups of yearly paid BMFA Members.]

NOTE: Any packing, shipping, or insurance costs during shipping are the responsibility of the artists.

The Selection Process

If selected for further consideration, the Exhibitions Committee Chair will contact you to set up a time for you to present 5-10 examples of the work you will exhibit.

You will bring your examples to the BMFA at the specified day and time. Appointments will be scheduled at ½ hour intervals. At the discretion of the Exhibitions Committee, the presentation may be done via ZOOM or a local RGV studio visit.

The Exhibitions Committee will present their recommendations of selected artists to the BMFA Board of Directors for final approval.

If you are selected for a Solo Exhibition or Group Exhibition:

- You will be assigned the space and time for your exhibition.
- You will sign a contract committing to that time frame.
- If that time slot is not acceptable to you, the Exhibitions Committee will solicit another exhibition for that space and time to fill the slot and you can reapply next year.
- You may want to provide a mockup for the layout of the exhibition. The Exhibitions Committee will collaborate with you in the final selection and installation of your work. Because of space limitations, it may not be possible to display all your work. We want to have an installation that allows breathing space around each piece and avoids the appearance of being cluttered or random.
- The presentation of two-dimensional pieces should feature simple frames with the emphasis on the artwork.
- Two-dimensional works and three-dimensional works:
 - original: not done in a class nor done under instruction and not a copy of another artist's / photographer's work, regardless of medium, i.e., painting, sculpture, photography, etc.
 - completed within the past five (5) years
- Two-dimensional works:
 - no giclées
 - paintings framed or on gallery wrapped canvas (no staples showing) and finished in such a manner that requires no framing
 - all works on paper: matted and framed under glass
 - hand-pulled artist's prints signed and numbered in series
 - all works securely framed, wired, and ready to hang
- You will be required to attend any opening / closing reception and to deliver a discussion of your work and to respond to audience questions. If asked, the Exhibitions Committee can assist you in preparing your Artist's Talk.
- No purchased work may be removed from the Gallery until the close of the exhibition. Any packing, shipping, or insurance costs for purchases are the responsibility of the artist.

UNIVERSITY OF NORTH TEXAS
AUSEUM of FINE ART
 60 E Ringgold St
 Rownsville, Texas 78520
 (562) 542-0941

MAP GM-001

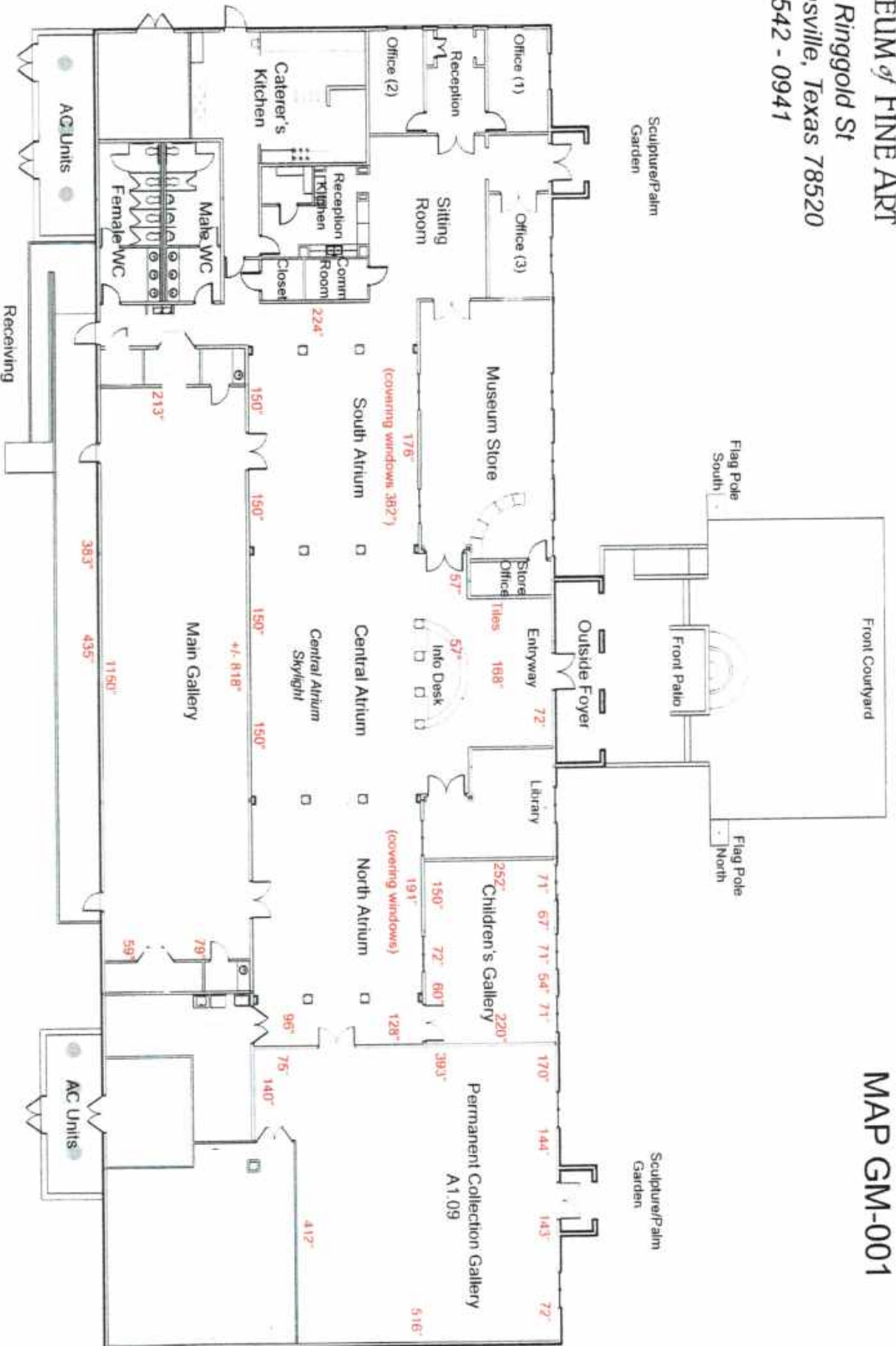

January 8, 2008
 Gallery Measurements